

DRYCONN®

WATERPROOF CONNECTORS

Filled Connectors for Direct Bury Use



Installation Instructions

IMPORTANT: Turn off power before installing or removing connector. Product to be used in accordance with local and national codes.

1. Strip wires 3/4" (19.1mm).
2. Align any frayed strands or conductors.
3. Pre-twisting unnecessary. Place stripped wires together with ends of insulation even.
4. Twist connector onto wires pushing firmly until hand-tight. Do not over torque.
5. Wipe sealant in and around conductors and connector opening while tightening. Do not reuse.

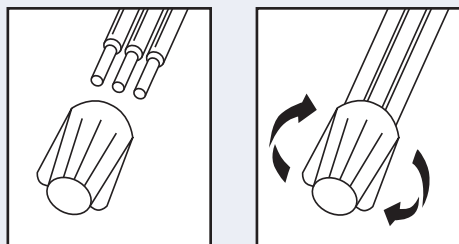

U.S. Pat. 5,113,037 and 5,771,578.
All other trademarks, U.S. & Foreign
Patents Apply. All Rights Reserved.

DryConn® Aqua/Blue

Catalog #	Selling Unit
62310	Card of 3
62325	Bag of 15
62335	Bag of 50
62340	Bag of 250

PRODUCT SPECIFICATIONS & MEASUREMENTS

Max. Voltage: 600V max. building wire
(1000V max. signs or luminaries)

Connector Size: 1 1/4" x 13/16"

Wire Type: Copper/Copper

Wire Range: Min #14/Max #6

Temperature Rating: 105°C (221°F)

Silicone Sealant Temperature: -45°F to 400°F

UL Designation: LWP*

Measurements (Inches):

A - 1.64

B - 0.82

C - 0.63

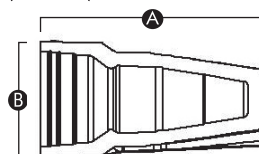

- UL 486D listed as a sealed wire connector system. For use in damp, wet, raintight, and submersible locations. Not to be used in continuous submersion applications.

Selected 600V Wire Combinations

2 #8	1 #10 w/3-5 #14	3 #10 w/1-2 #18
2-3 #10	2 #10 w/1-2 #12	4 #12 w/1 #14
3-5 #12	2 #10 w/1-3 #14	1 #10 w/2-3 #12
3 #10 w/1 #14		